

ACCUEVERGY

AcuCT Hinged Series

Compact Split-Core Current Transformer



D A T A S H E E T

AcuCT Hinged Series

AcuCT-H040

Compact Split-Core Current Transformer
Datasheet



Featuring an ultra-compact design with a convenient, hinged opening, the AcuCT Hinged split-core current transformers are high-accuracy sensors that are ideally-suited for branch circuit monitoring in crowded electrical panels. The installer-friendly, hinged design facilitates fast installation without cable or wire disconnection.

Features

- High accuracy: 0.5% from 10%-120% of rated current
- Features an inherently-safe, 333mV output
- Quick installation thanks to hinged Split-Core design
- Compact design is ideal for electrical panels with limited space
- UL Recognized



Accuenergy (Canada) Inc.

Los Angeles - Toronto - Beijing - Pretoria

North America Toll Free: 1-877-721-8908

Web: www.accuenergy.com

Email: marketing@accuenergy.com

Revision Date: Sep 2021 Version: 1.0.0
Specs Subject To Change Without Notice.



Specifications

RATED CURRENT	5A, 20A, 30A, 40A, 50A, 60A
Current Range	10% - 120% of rated current
Output	333mV
Accuracy	0.5%

MECHANICAL/ENVIRONMENTAL

Form Factor	Hinged Split-Core CT
Window Size	10.2mm (0.40")
Exterior Dimensions	29.4mm x 26.4mm x 41.7mm 1.16" x 1.04" x 1.64"
Case Material	Black Nylon, UL 94V-0
Lead Wires	2.5m (8ft) twisted pair, 26AWG
Operating Temperature	-15°C to 60°C / 5°F to 140°F
Operating Humidity	Non-condensing, 0 to 95% RH
Installation Conditions	Indoor Use

ELECTRICAL

Wire Polarity	White=Positive, Black=Negative
Phase Orientation	Arrow Points Towards Load
Frequency Range	50-1KHz
Burden	20A: 33.3Ω / 30A: 33.3Ω / 40A: 25Ω / 50A: 20Ω / 60A: 16.66Ω

SAFETY/COMPLIANCE

Rated Voltage	600Vac, Category III
Certifications	CE, RoHS, cURus (E359521)

Dimensions

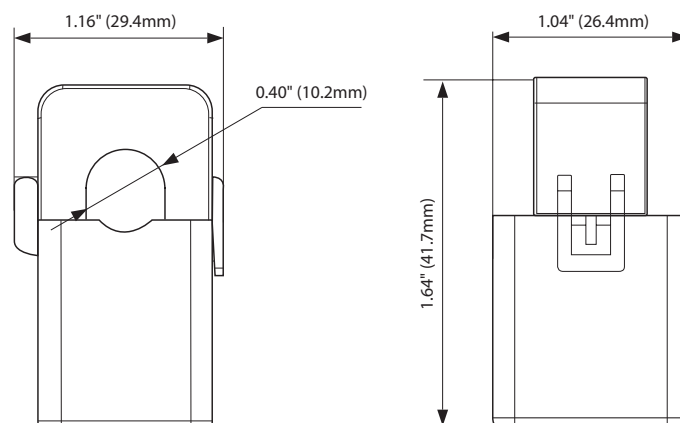

Ordering Information

Ordering Number	Rated Input		Rated Output	
	AcuCT- H040	-	:	:333
Ordering Example	AcuCT- H040	-	20	: :333
			5: 5A	
			20: 20A	
			30: 30A	
			40: 40A	
			50: 50A	
			60: 60A	

AcuCT Hinged Series

AcuCT-H063

Compact Split-Core Current Transformer
Datasheet



Featuring an ultra-compact design with a convenient, hinged opening, the AcuCT Hinged split-core current transformers are high-accuracy sensors that are ideally-suited for branch circuit monitoring in crowded electrical panels. The installer-friendly, hinged design facilitates fast installation without cable or wire disconnection.

Features

- High accuracy: 0.5% from 10%-120% of rated current
- Features an inherently-safe, 333mV output
- Quick installation thanks to hinged Split-Core design
- Compact design is ideal for electrical panels with limited space
- UL Recognized



Accuenergy (Canada) Inc.

Los Angeles - Toronto - Beijing - Pretoria
North America Toll Free: 1-877-721-8908
Web: www.accuenergy.com
Email: marketing@accuenergy.com

Revision Date: Sep 2021 Version: 1.0.0
Specs Subject To Change Without Notice.



Specifications

RATED CURRENT		50A, 100A, 150A
Current Range		10% - 120% of rated current
Output		333mV
Accuracy		0.5%
MECHANICAL/ENVIRONMENTAL		
Form Factor		Hinged Split-Core CT
Window Size		16.0mm (0.63")
Exterior Dimensions		36.0mm x 30.5mm x 53.0mm 1.42" x 1.20" x 2.09"
Case Material		Black Nylon, UL 94V-0
Lead Wires		2.5m (8ft) twisted pair, 26AWG
Operating Temperature		-15°C to 60°C / 5°F to 140°F
Operating Humidity		Non-condensing, 0 to 95% RH
Installation Conditions		Indoor Use
ELECTRICAL		
Wire Polarity		White=Positive, Black=Negative
Phase Orientation		Arrow Points Towards Load
Frequency Range		50-1KHz
Burden		50A: 20Ω / 100A: 10Ω / 150A: 6.66Ω
SAFETY/COMPLIANCE		
Rated Voltage		600Vac, Category III
Certifications		CE, RoHS, cURus (E359521)

Dimensions

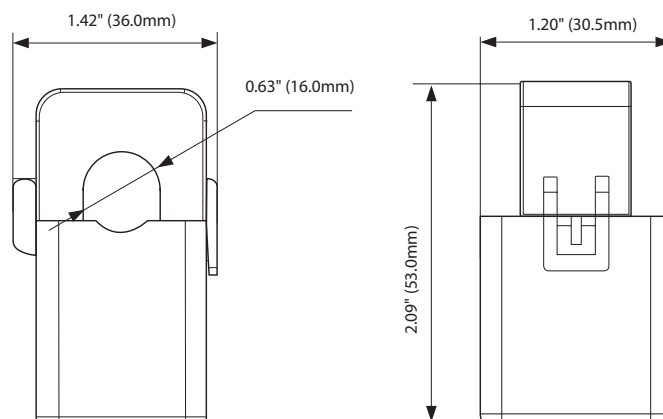

Ordering Information

		Rated Input	Rated Output
Ordering Number	AcuCT- H063	-	: :333
Ordering Example	AcuCT- H063	- 50	: :333
		50: 50A	
		100: 100A	
		150: 150A	

AcuCT Hinged Series

AcuCT-H100

Compact Split-Core Current Transformer
Datasheet



Featuring an ultra-compact design with a convenient, hinged opening, the AcuCT Hinged split-core current transformers are high-accuracy sensors that are ideally-suited for branch circuit monitoring in crowded electrical panels. The installer-friendly, hinged design facilitates fast installation without cable or wire disconnection.

Features

- High accuracy: 0.5% from 10%-120% of rated current
- Features an inherently-safe, 333mV output
- Quick installation thanks to hinged Split-Core design
- Compact design is ideal for electrical panels with limited space
- UL Recognized



Accuenergy (Canada) Inc.

Los Angeles - Toronto - Beijing - Pretoria

North America Toll Free: 1-877-721-8908

Web: www.accuenergy.com

Email: marketing@accuenergy.com

Revision Date: Sep 2021 Version: 1.0.0
Specs Subject To Change Without Notice.



Specifications

RATED CURRENT	
Rated Current	100A, 120A, 200A, 250A
Current Range	10% - 120% of rated current
Output	333mV
Accuracy	0.5%
MECHANICAL/ENVIRONMENTAL	
Form Factor	Hinged Split-Core CT
Window Size	25.4mm (1.00")
Exterior Dimensions	50.8mm x 38.6mm x 70.1mm 2.00" x 1.52" x 2.76"
Case Material	Black Nylon, UL 94V-0
Lead Wires	2.5m (8ft) twisted pair, 26AWG
Operating Temperature	-15°C to 60°C / 5°F to 140°F
Operating Humidity	Non-condensing, 0 to 95% RH
Installation Conditions	Indoor Use
ELECTRICAL	
Wire Polarity	White=Positive, Black=Negative
Phase Orientation	Arrow Points Towards Load
Frequency Range	50-1KHz
Burden	100A: 10Ω / 120A: 8.33Ω / 200A: 5Ω / 250A: 4Ω
SAFETY/COMPLIANCE	
Rated Voltage	600Vac, Category III
Certifications	CE, RoHS, cURus (E359521)

Dimensions

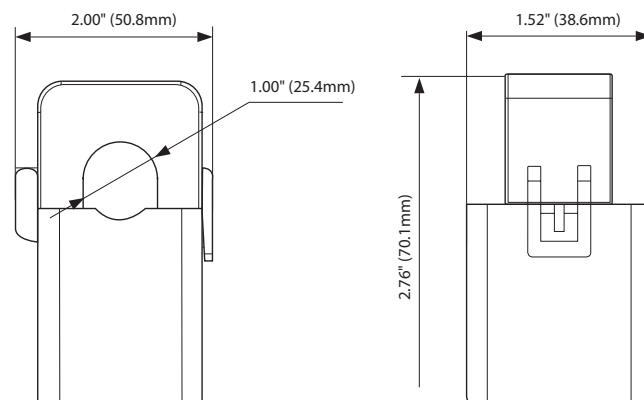

Ordering Information

		Rated Input		Rated Output	
Ordering Number	AcuCT- H100	-	:	:	333
Ordering Example	AcuCT- H100	-	120	:	333
		100:	100A		
		120:	120A		
		200:	200A		
		250:	250A		

AcuCT Hinged Series

AcuCT-H138

Compact Split-Core Current Transformer
Datasheet



Featuring an ultra-compact design with a convenient, hinged opening, the AcuCT Hinged split-core current transformers are high-accuracy sensors that are ideally-suited for branch circuit monitoring in crowded electrical panels. The installer-friendly, hinged design facilitates fast installation without cable or wire disconnection.

Features

- High accuracy: 0.5% from 10%-120% of rated current
- Features an inherently-safe, 333mV output
- Quick installation thanks to hinged Split-Core design
- Compact design is ideal for electrical panels with limited space
- UL Recognized



Accuenergy (Canada) Inc.

Los Angeles - Toronto - Beijing - Pretoria
North America Toll Free: 1-877-721-8908
Web: www.accuenergy.com
Email: marketing@accuenergy.com

Revision Date: Sep 2021 Version: 1.0.0
Specs Subject To Change Without Notice.



Specifications

RATED CURRENT		200A, 400A, 600A
Current Range		10% - 120% of rated current
Output		333mV
Accuracy		0.5%
MECHANICAL/ENVIRONMENTAL		
Form Factor		Hinged Split-Core CT
Window Size		35.0mm (1.40")
Exterior Dimensions		65.00mm x 40.00mm x 83.00mm 2.56" x 1.57" x 3.27"
Case Material		Black Nylon, UL 94V-0
Lead Wires		2.5m (8ft) twisted pair, 26AWG
Operating Temperature		-15°C to 60°C / -5°F to 140°F
Operating Humidity		Non-condensing, 0 to 95% RH
Installation Conditions		Indoor Use
ELECTRICAL		
Wire Polarity		White=Positive, Black=Negative
Phase Orientation		Arrow Points Towards Load
Frequency Range		50-1KHz
Burden		200A: 5Ω / 400A: 5Ω / 600A: 3.33Ω
SAFETY/COMPLIANCE		
Rated Voltage		600Vac, Category III
Certifications		CE, RoHS, cURus (E359521)

Dimensions

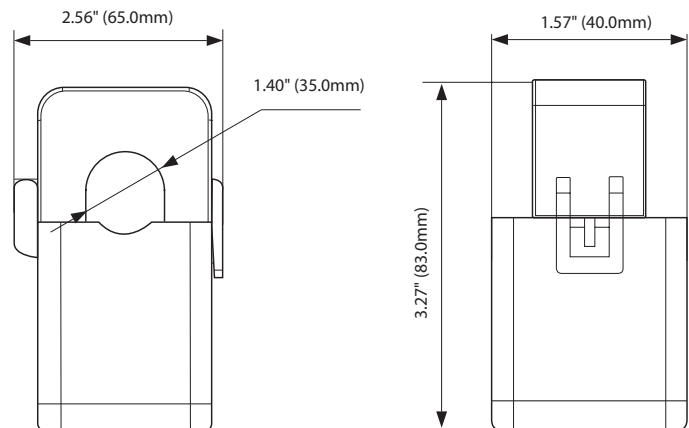

Ordering Information

		Rated Input	Rated Output
Ordering Number	AcuCT- H138	-	: :333
Ordering Example	AcuCT- H138	- 200	: :333
		200: 200A	
		400: 400A	
		600: 600A	