

# CURRENT TRANSFORMER

Model 5DARL

Window Diameter 1.56"

APPLICATION:  
Ammeters, wattmeters, and  
cross current compensation.

FREQUENCY:  
50-400 Hz.

INSULATION LEVEL:  
600 Volts, 10 kv BIL full wave.

REGULATORY AGENCY APPROVALS



E93779



LRB9403

Manufactured to meet the requirements of ANSI/IEEE C57.13.  
Classified by U.L. in accordance with IEC 44-1

- Flexible leads are UL 1015 105 ° C, CSA approved, #16 AWG, 24" long.
- Non-standard lead length can be specified.
- Approximate weight: 2 lbs.

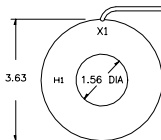
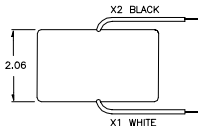
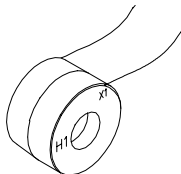

EXCITATION CURVE

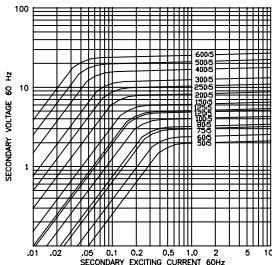
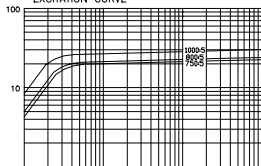

| CATALOG NUMBER | CURRENT RATIO | V.A. FOR ±1% CLASS | ANSI METERING CLASS at 60 Hz |      |      |      |      | SECONDARY WINDING RESISTANCE (MΩ @ 75 ° C) | CONTINUOUS THERMAL RATING FACTOR |       |
|----------------|---------------|--------------------|------------------------------|------|------|------|------|--|----------------------------------|-------|
|                |               |                    | B0.1                         | B0.2 | B0.5 | B0.9 | B1.8 |  | @30°C                            | @55°C |
| 5DARL-500      | 50:5          | 12.5               | 2.4                          | -    | -    | -    | -    | 0.010                                      | 2.0                              | 2.0   |
| 5DARL-600      | 60:5          | 2.5                | 1.2                          | 4.8  | -    | -    | -    | 0.014                                      | 2.0                              | 2.0   |
| 5DARL-750      | 75:5          | 3.5                | 1.2                          | 2.4  | -    | -    | -    | 0.018                                      | 2.0                              | 2.0   |
| 5DARL-800      | 80:5          | 4.0                | 1.2                          | 2.4  | 4.8  | -    | -    | 0.021                                      | 2.0                              | 2.0   |
| 5DARL-101      | 100:5         | 5.0                | 0.6                          | 1.2  | 4.8  | 4.8  | -    | 0.029                                      | 2.0                              | 2.0   |
| 5DARL-121      | 120:5         | 7.5                | 0.6                          | 0.6  | 2.4  | 4.8  | -    | 0.035                                      | 2.0                              | 2.0   |
| 5DARL-1250     | 125:5         | 7.5                | 0.6                          | 0.6  | 2.4  | 4.8  | 4.8  | 0.036                                      | 2.0                              | 2.0   |
| 5DARL-151      | 150:5         | 10.0               | 0.6                          | 0.6  | 1.2  | 2.4  | 4.8  | 0.042                                      | 2.0                              | 2.0   |
| 5DARL-201      | 200:5         | 12.5               | 0.6                          | 0.6  | 0.6  | 1.2  | 2.4  | 0.058                                      | 2.0                              | 1.5   |
| 5DARL-251      | 250:5         | 20.0               | 0.3                          | 0.3  | 0.6  | 1.2  | 2.4  | 0.078                                      | 2.0                              | 1.5   |
| 5DARL-301      | 300:5         | 25.0               | 0.3                          | 0.3  | 0.6  | 1.2  | 1.2  | 0.084                                      | 1.5                              | 1.33  |
| 5DARL-401      | 400:5         | 40.0               | 0.3                          | 0.3  | 0.3  | 0.6  | 1.2  | 0.111                                      | 1.5                              | 1.0   |
| 5DARL-501      | 500:5         | 50.0               | 0.3                          | 0.3  | 0.3  | 0.3  | 0.6  | 0.175                                      | 1.5                              | 1.0   |
| 5DARL-601      | 600:5         | 60.0               | 0.3                          | 0.3  | 0.3  | 0.3  | 0.6  | 0.152                                      | 1.0                              | 0.8   |
| 5DARL-751      | 750:5         | 70.0               | 0.3                          | 0.3  | 0.3  | 0.3  | 0.6  | 0.190                                      | 1.33                             | 1.0   |
| 5DARL-801      | 800:5         | 75.0               | 0.3                          | 0.3  | 0.3  | 0.3  | 0.3  | 0.202                                      | 1.33                             | 1.0   |
| 5DARL-102      | 1000:5        | 90.0               | 0.3                          | 0.3  | 0.3  | 0.3  | 0.3  | 0.316                                      | 1.0                              | 0.8   |