

# CURRENT TRANSFORMER

Model CTWH4-75-T100

*Wound primary CT*

REGULATORY AGENCY APPROVALS



Manufactured to meet the requirements of ANSI/IEEE C57.13.  
Classified by UL in accordance with EC 44-1

APPLICATION:  
Metering and relaying.  
FREQUENCY:  
50-400 Hz.  
MAXIMUM SYTEM VOLTAGE:  
9.52kV, BIL 75kV full wave.  
CONTINUOUS THERMAL  
CURRENT RATING FACTOR:  
1.50 at 30°C. amb., 1.33 at 55°C. amb.  
250:5 and 1000:5A  
1.10 at 30°C. amb., 0.85 at 55°C. amb.  
1200:5A  
1.0 at 30°C. amb., 0.75 at 55°C. amb.

- Primary terminals are plated copper bars. See chart below for sizes.
- Secondary terminals are brass screws No. 10-32 with one flatwasher and lockwasher.
- Vacuum cast in polyurethane resin.
- Other ratios, secondary currents and dual ratios are available. Refer to factory.
- The transformers are tested for partial discharge to Canadian Standards CAN3-C13-MB3. This test can also be carried out to IEC requirements if requested.
- Approximate weight 42 lbs.

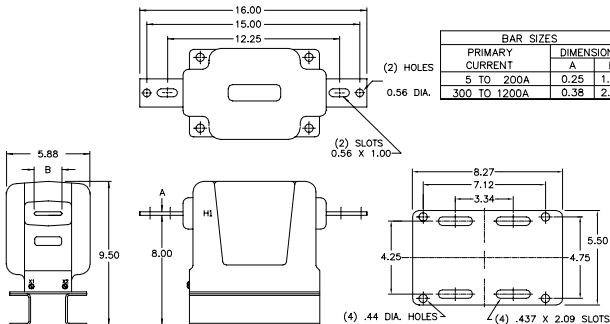

BAR SIZES		
PRIMARY CURRENT	DIMENSIONS	
	A	B
5 TO 200A	0.25	1.50
300 TO 1200A	0.38	2.00

CATALOG NUMBER	CURRENT RATIO	RELAY CLASS	ANSI METERING CLASS AT 60 Hz					*THERMAL CURRENT RATING 1 SECOND RMS AMPS
			B0.1	B0.2	B0.5	B0.9	B1.8	
CTWH4-75-T100-050	5:5	T100	0.3	0.3	0.3	0.3	0.3	470
CTWH4-75-T100-100	10:5	T100	0.3	0.3	0.3	0.3	0.3	900
CTWH4-75-T100-150	15:5	T100	0.3	0.3	0.3	0.3	0.3	1600
CTWH4-75-T100-200	20:5	T100	0.3	0.3	0.3	0.3	0.3	1900
CTWH4-75-T100-250	25:5	T100	0.3	0.3	0.3	0.3	0.3	2600
CTWH4-75-T100-300	30:5	T100	0.3	0.3	0.3	0.3	0.3	2900
CTWH4-75-T100-400	40:5	T100	0.3	0.3	0.3	0.3	0.3	3800
CTWH4-75-T100-500	50:5	T100	0.3	0.3	0.3	0.3	0.3	4700
CTWH4-75-T100-750	75:5	T100	0.3	0.3	0.3	0.3	0.3	5900
CTWH4-75-T100-101	100:5	T100	0.3	0.3	0.3	0.3	0.3	8600
CTWH4-75-T100-151	150:5	T100	0.3	0.3	0.3	0.3	0.3	12900
CTWH4-75-T100-201	200:5	T100	0.3	0.3	0.3	0.3	0.3	17200
CTWH4-75-T100-251	250:5	T100	0.3	0.3	0.3	0.3	0.3	17200
CTWH4-75-T100-301	300:5	T100	0.3	0.3	0.3	0.3	0.3	34500
CTWH4-75-T100-401	400:5	T100	0.3	0.3	0.3	0.3	0.3	34500
CTWH4-75-T100-601	600:5	T100	0.3	0.3	0.3	0.3	0.3	66200
CTWH4-75-T100-801	800:5	T100	0.3	0.3	0.3	0.3	0.3	66200
CTWH4-75-T100-102	1000:5	T100	0.3	0.3	0.3	0.3	0.3	66200
CTWH4-75-T100-122	1200:5	T100	0.3	0.3	0.3	0.3	0.3	66200

\* With a burden of B0.1 or greater connected to the secondary.

# CTWH4-75-T100

## RECOMMENDED MINIMUM SPACINGS

A; Unit to Unit  
= 1.00" minimum.

B; HV to Ground in Air  
= 4.50" minimum.

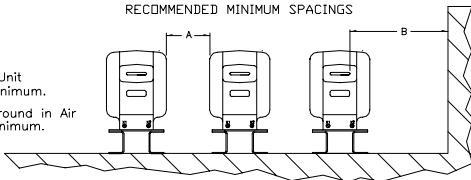

Recommended spacings are for guidance only. User needs to set appropriate values to assure performance for high potential test, impulse test, high humidity, partial discharge, high altitude, and other considerations like configuration.

